

Instant Tattoo

3

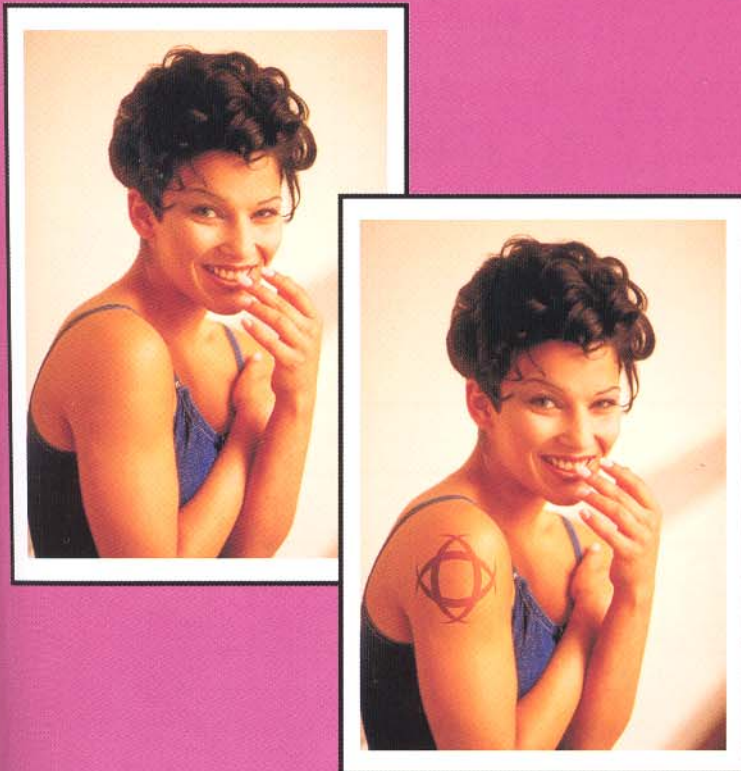

Are you one of those people who always wanted to get a tattoo but wasn't ready to make the commitment? Are you afraid of the pain? Worried about how it'll look when it's done? Don't want to be 80 years old and covered in tattoos? If you want to preview how a tattoo would look without having to make the commitment, then Photoshop is your answer. In this project, you'll create a tattoo from scratch and then apply it to a woman's arm. Once you get the hang of making and adjusting selections, you can create many types of wild and interesting shapes for your tattoos. Once the tattoo is created, you'll manipulate it to fit on the arm and then adjust the opacity to make it look realistic.



Project Files

The file for this project is called `tattoo.tif` and can be found at:
www.mimosabooks.com/files



Completion Time

After the files have been downloaded, this project should take approximately ten minutes to fifteen minutes to complete.



Degree of Difficulty



Project Tools



Elliptical Marquee Tool



Move Tool



Magic Wand Tool



Palettes

Ensure the following palettes, which can be accessed from the Window menu, are open for this project:

Tools

Layers

STEP 1 : OPEN THE TUTORIAL

Before we can get any work done, we need to first open the file we'll be using in this project.

- A. Press Ctrl+O (PC) or Command+O (Mac) to launch the Open dialog box.
- B. Browse to the folder where you saved the tutorial files.
- C. Click on the file entitled "tattoo.tif." It will be highlighted.
- D. Click the Open button. The file will open.
- E. Click the Maximize button to expand the window to fit the screen.
- F. Press Ctrl+O (PC) or Command+O (Mac) to fit the image to the screen.

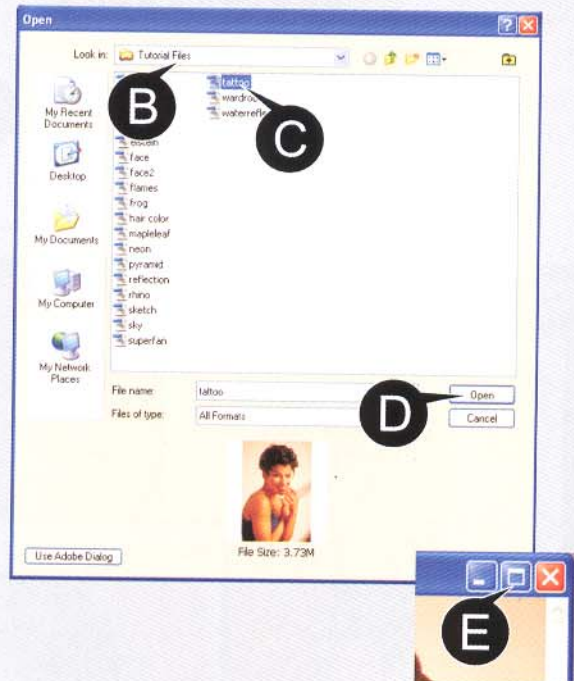

PHOTOGRAPHY 101

The Rule of Thirds - One of the most basic, yet important principles of photography is the rule of thirds. This rule deals with the alignment of objects in your photograph. The common thought is to simply align your subject so that it will be in the center of the photograph. This, however, goes against the rule of thirds. To apply the rule of thirds, you have to imagine that your photograph is divided into thirds both horizontally and vertically. The easiest way to imagine this is to picture that three horizontal and three vertical lines are running through your photograph. The four locations where the lines intersect are your "subject zones." In the image seen here, these "subject zones" are illustrated by four red circles. It's in these zones that you should align the key elements of your photograph. While you don't have to follow the rule of thirds for every shot, it's a good idea to get into the habit of following it for most of your pictures.

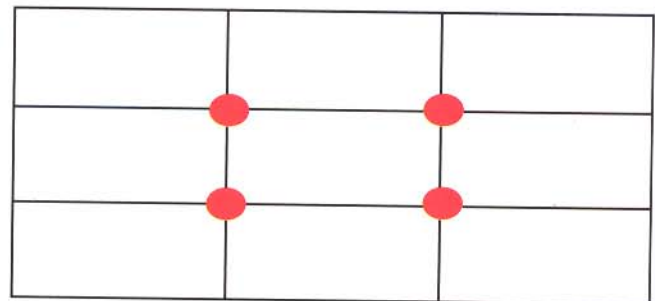

STEP 2 : CREATING THE TATTOO

We are going to create the tattoo from scratch in a new document.

- A. Press Ctrl+N (PC) or Command+N (Mac) to bring up the New dialog box.
- B. Type 300 into the Width, Height and Resolution fields. All the units of measurements for these three should be pixels.
- C. Click OK. A new blank document will appear.
- D. Click and hold the Rectangular Marquee Tool button. A list of options will appear.
- E. Click the Elliptical Marquee Tool option.
- F. Click and drag starting from near the top left corner to the bottom right to create an elliptical selection.
- G. Click the "Subtract from selection" button on the options bar.
- H. Position the mouse pointer up and to the left of the selection.
- I. Click and drag downward and to the right so that the two elliptical objects are overlapping with a half moon shape remaining at the bottom. When you release the mouse button, you'll be left with a half-moon shape.

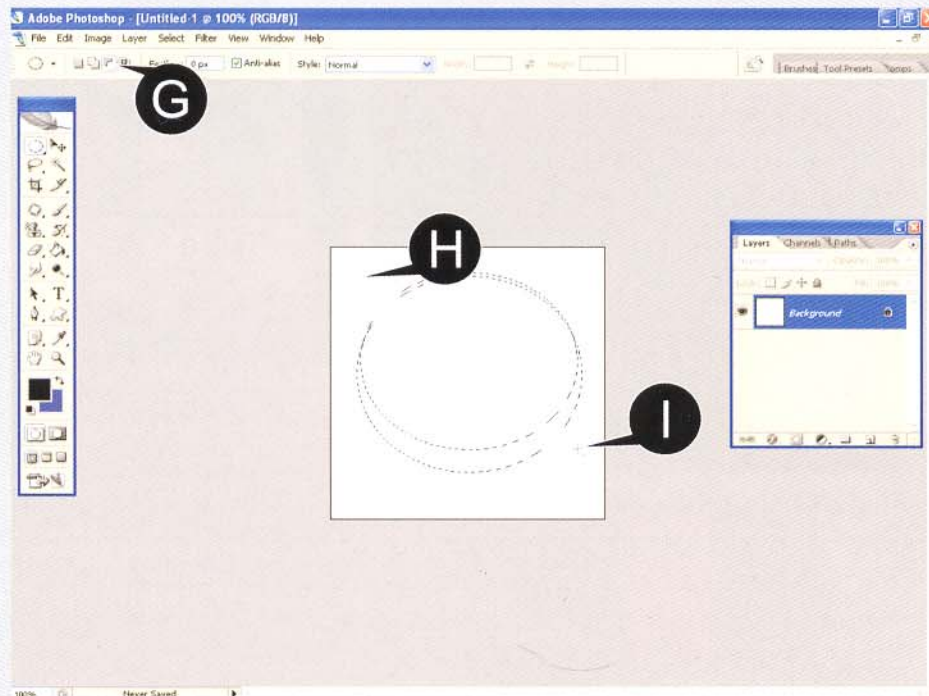
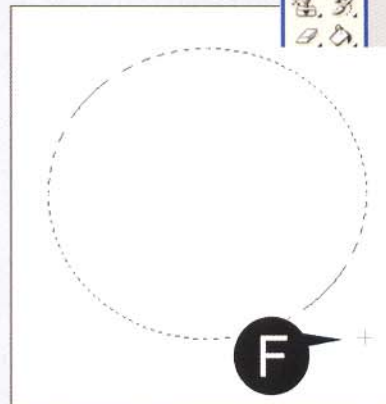
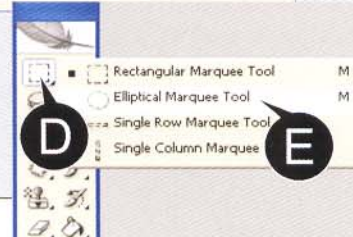
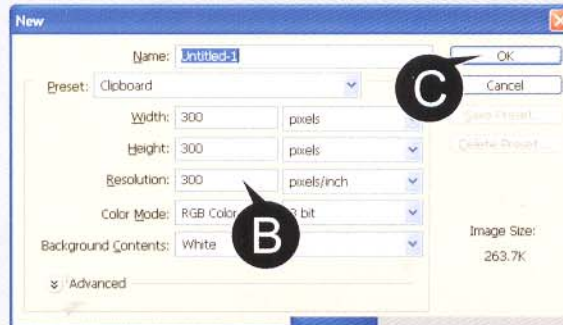

STEP 3 : FILLING THE SELECTION

The next step is to fill the half-moon selection with some color. We'll do this by using the Fill command.

A. Click Edit | Fill. The Fill dialog box will appear.

B. Click the arrow beside the Use box to see a list of fill options.

C. Click Color. The Color dialog box will appear.

D. Click on the color "black" or enter 0 in the R, G, and B fields.

E. Click OK. You'll return to the Fill dialog box.

F. Click OK. The selection will be filled with black.

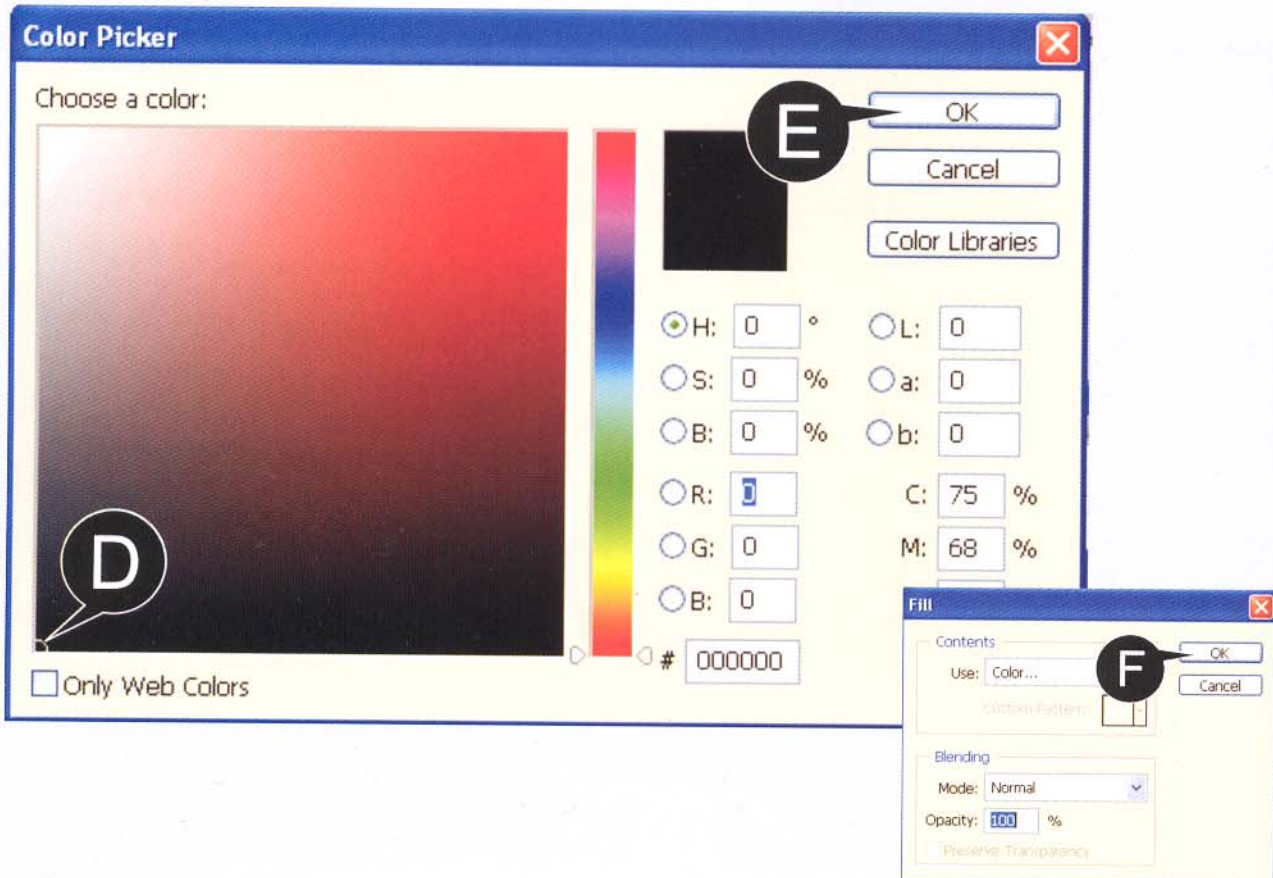
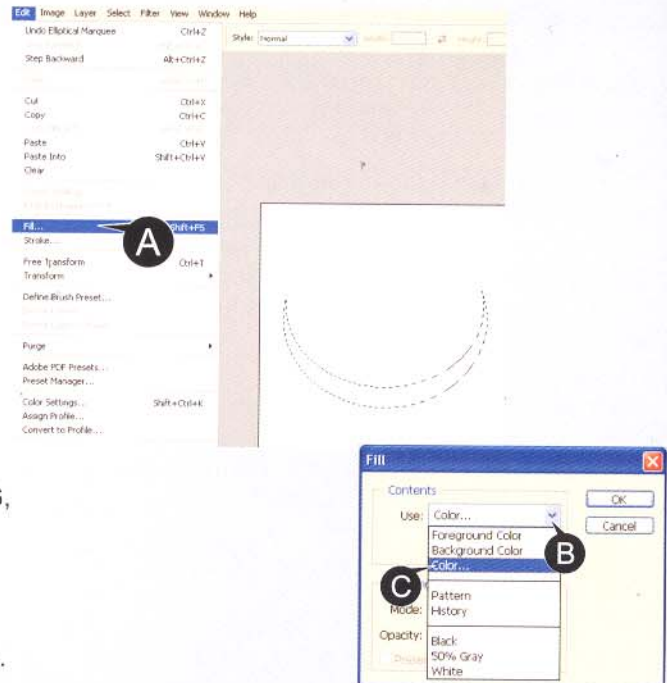

STEP 4 : MAKING THE TATTOO

In order to make the tattoo we are simply going to duplicate the shape we created several times and rotate it in different directions to create an interesting shape.

A. Press Ctrl+J (PC) or Command+J (Mac) to make a layer from the selected area.

B. Click the Move Tool button. A series of handles will appear around the object.

C. Position the mouse pointer just outside the top right handle. You'll know you are in the right position when the mouse pointer turns into a curved, double-sided arrow.

D. Click and drag upward and to the left. As you drag, the shape will rotate. Continue dragging until the shape is completely flipped.

E. Press the Commit button on the options bar.

F. Press Ctrl+J (PC) or Command+J (Mac) to make a layer from the selected area.

G. Position the mouse pointer just outside the bottom right handle. You'll know you are in the right position when the mouse pointer turns into a curved, double-sided arrow.

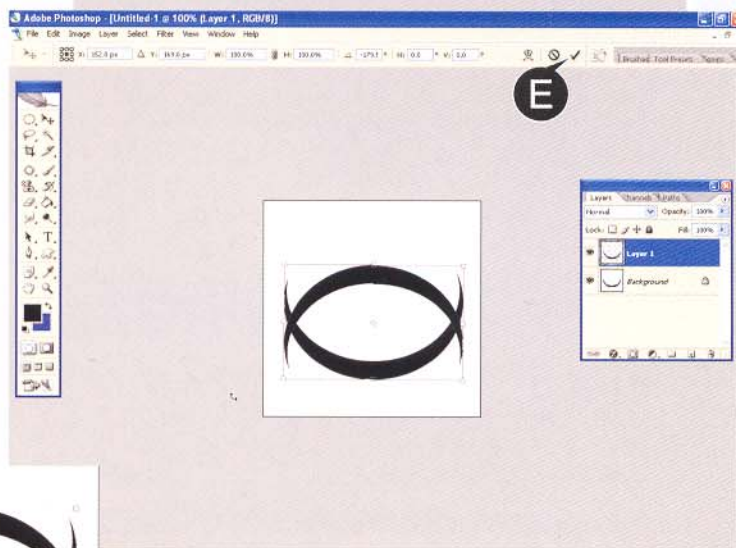
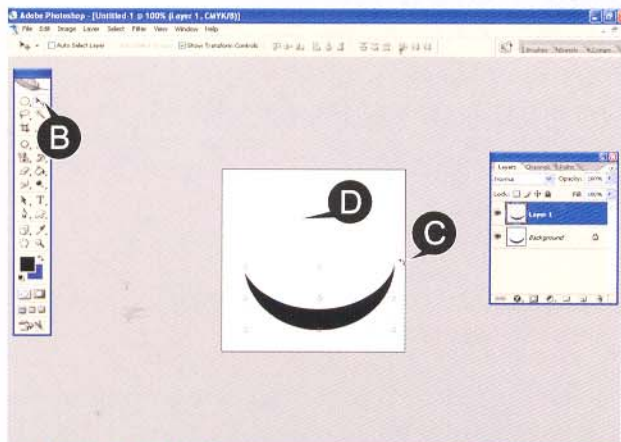

Holding down the Alt key while creating a selection is the equivalent of pressing the “Add to selection” button on the toolbar. In other words, you can quickly add to an existing selection by holding down the Alt key as you click and drag.



STEP 4 : MAKING THE TATTOO CONT.

H. Click and drag upward and to the left. As you drag the shape will rotate. Continue dragging until the shape has rotated 90 degrees.

I. Press the Commit button on the options bar.

J. Press Ctrl+J (PC) or Command+J (Mac) to make a layer from the selected area.

K. Position the mouse pointer just outside the bottom right handle. You'll know you are in the right position when the mouse pointer turns into a curved, double-sided arrow.

L. Click and drag upward. As you drag the shape will rotate. Continue dragging until the shape has rotated 90 degrees.

M. Press the Commit button on the options bar.

N. Click Layer | Merge Visible. All of the layers will be combined together.

O. Press Ctrl+A (PC) or Command+A (Mac) to select the entire tattoo image.

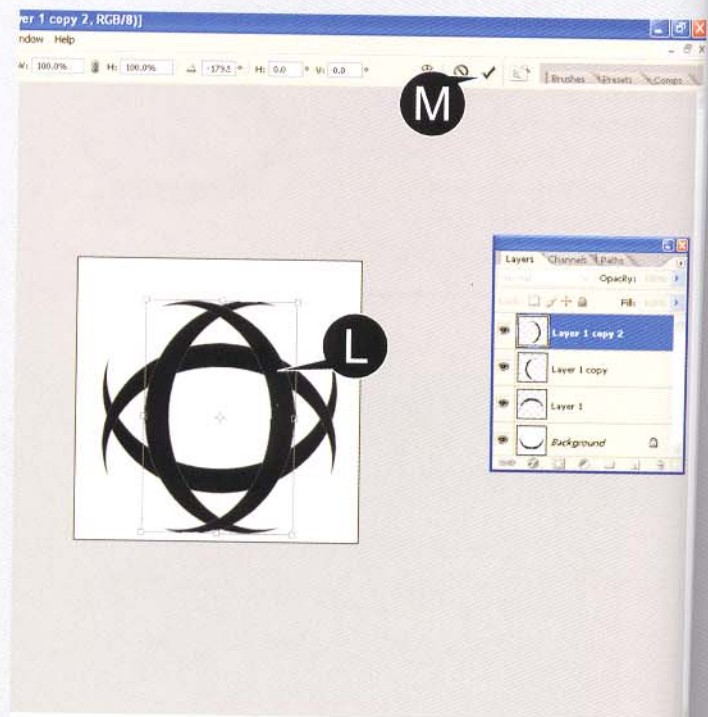
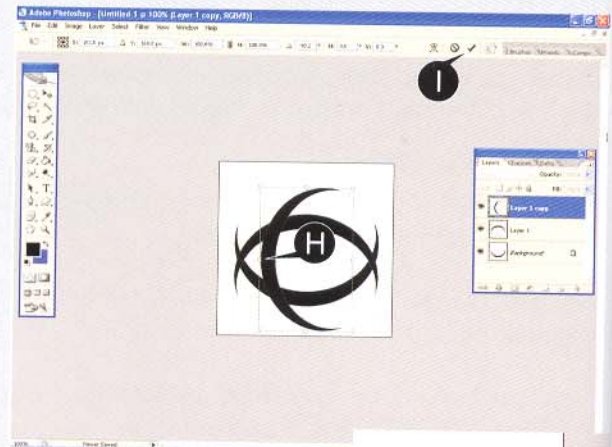

STEP 5 : IMPORTING THE TATTOO

To bring the tattoo into our photo image of the woman, we will simply copy and paste it. Once we have the tattoo in our image, we'll adjust it to make it look realistic. Part of the adjustment will be to remove the white background.

- A. Press Ctrl+C (PC) or Command+C (Mac) to copy the tattoo.
- B. Click Window | tattoo.tif. You'll switch to the image of the woman.
- C. Press Ctrl+V (PC) or Command+V (Mac) to paste the tattoo.
- D. Click the Move Tool button. A series of handles will appear around the tattoo.
- E. Position the mouse pointer over the middle of the tattoo. Click and drag it until it is over the woman's shoulder.
- F. Position the mouse pointer over the middle right handle. Click and drag inward slightly to squish the tattoo.
- G. Repeat Step F with the middle left handle.
- H. Click the Commit button on the options bar.

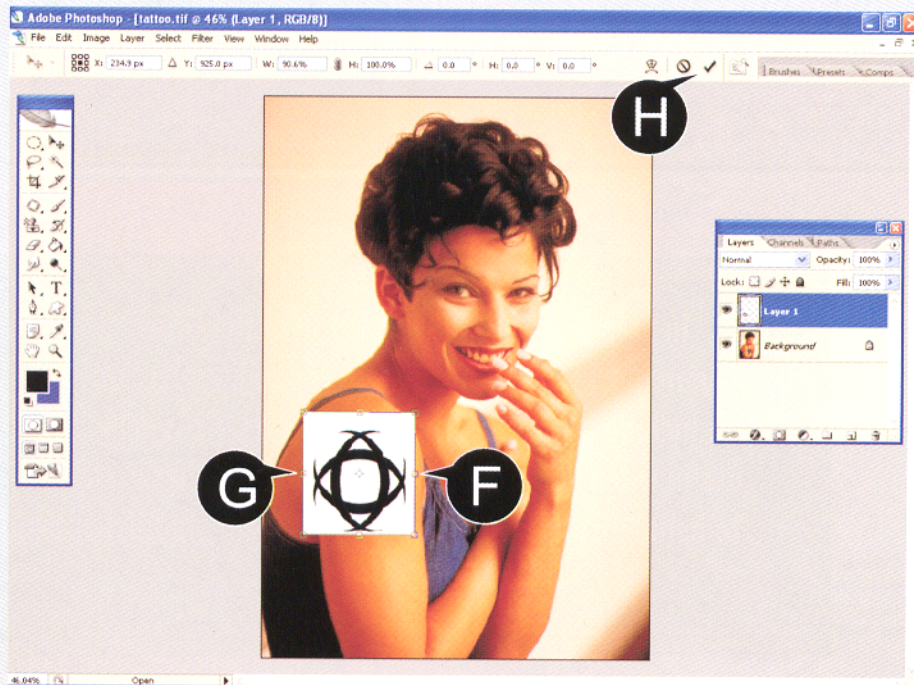
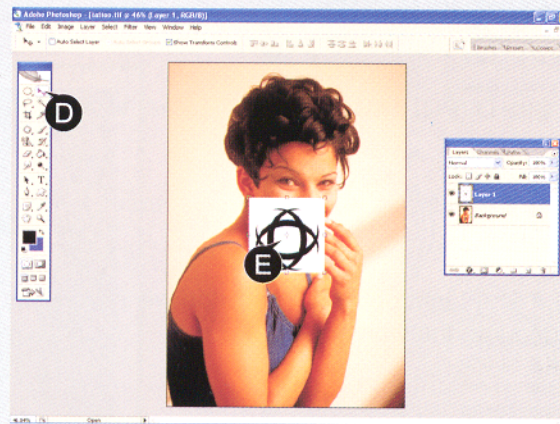
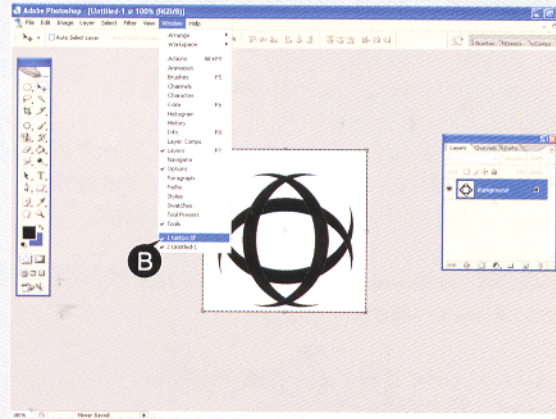

STEP 5 : IMPORTING THE TATTOO CONT.

- I. Click the Magic Wand Tool button.
- J. Check the Anti-Alias box, if there is not already a checkmark in it. Make sure any of the other boxes in the options bar are not selected.
- K. Click on any white area of the tattoo. A selection will be created.
- L. Click Select | Grow. The selection will grow slightly.
- M. Press the Delete key on the keyboard. The white portion of the tattoo will be removed.
- N. Press Ctrl+D (PC) or Command+D (Mac) to remove the selection.
- O. Click the Blend Mode button in the Layers palette.
- P. Click the Soft Light option. The tattoo will now appear faded into the woman's arm.

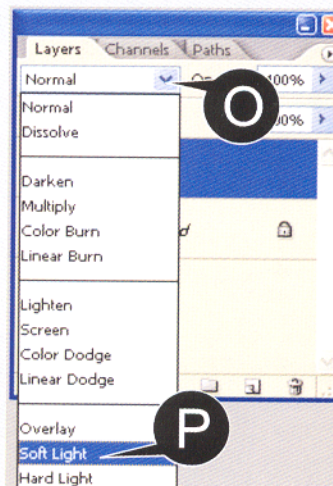
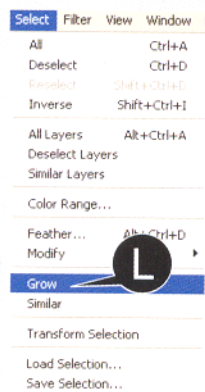
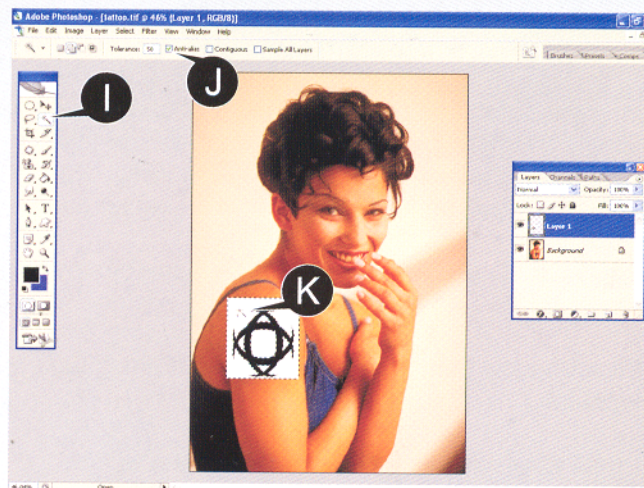

In Step 5 above, you made use of the Grow command. This command will expand a selection to include a region with similar colors. It is very useful when you have created a selection that is close to being just right but needs to be slightly adjusted to add an adjacent region.

